

系列规格表
Series Specification
Sheet

纽扣常规系列
Button regular series

系列名称 Series name	HESC系列 HESC series		
额定电压V _R Rated voltage	5.5V常规 5.5V (Conventional)	5.5V(高温电解液) 5.5V(High temperature electrolyte)	5.5V(三层) 5.5V(Three layers)
工作温度 Working temperature range	-40~70°C	-20~85°C	-40~85°C
容量范围 Capacitance range	0.1F~4F	1.0F~1.5F	0.47F~1F
容量偏差 Capacitance tolerance	-20%~+80%	-20%~+80%	-20%~+80%
使用寿命 Cycle life	额定电压到半额定电压间充放电循环50万次 Charging and discharging between rated voltage and half rated voltage >50000 cycles		



产品性能表
Product performance
table

纽扣常规系列—V型
Button regular series-V

型号 Model	额定电压/V Rated voltage	标称容量/F Rated discharge capacitance	内阻(1KHz)/Q Nominal impedance(1KHz)/Ω	漏电流(24h)/mA Leakage current (24 h)/mA	Φ/mm Diameter	H/mm Height/mm	P/mm Spacing/mm
HESC5R5104Z-V(Z009)	5.5	0.1	≤65	≤0.005	9.5	14.1	4.5
HESC5R5224Z-V(Z009)	5.5	0.22	≤65	≤0.005	9.5	14.1	4.5
HESC5R5334Z-V(Z009)	5.5	0.33	≤65	≤0.005	9.5	14.1	4.5
HESC5R5224Z-V(Z011)	5.5	0.22	≤50	≤0.005	11.5	16.5	4.5
HESC5R5334Z-V(Z011)	5.5	0.33	≤50	≤0.005	11.5	16.5	4.5
HESC5R5474Z-V(Z011)	5.5	0.47	≤50	≤0.005	11.5	16.5	4.5
HESC5R5105Z-V	5.5	1	≤20	≤0.02	19	23	4.5
HESC5R5155Z-V	5.5	1.5	≤20	≤0.02	19	23	4.5
HESC5R5405Z-V	5.5	4	≤16	≤0.03	25	29,0	6

产品图纸
Product drawings

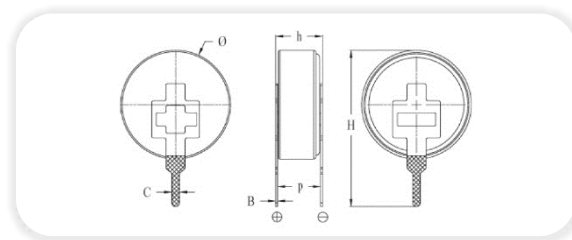

容量高，内阻低，一致性好。
High capacity, low internal
resistance, good consistency

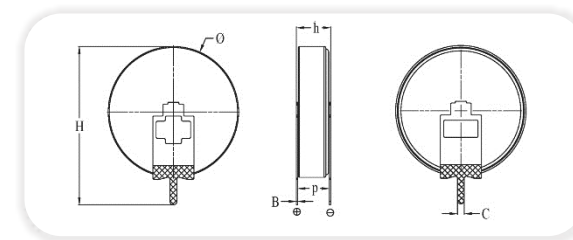

0.1~4.0F 电容示意图
diagram of capacitance

产品性能表
Product performance
table

纽扣常规系列-H型
Button regular series-H

型号 Model	额定电压/V Rated voltage	标称容量/F Rated discharge capacitance	内阻(1KHz)/Q Nominal impedance(1KHz)/Ω	漏电流(24h)/mA Leakage current (24 h)/mA	Φ/mm Diameter	H/mm Height/mm	P/mm Spacing/mm
HESC5R5104Z-H(Z009)	5.5	0.1	≤65	≤0.005	9.5	8.6	10.0
HESC5R5224Z-H(Z009)	5.5	0.22	≤65	≤0.005	9.5	8.6	10.0
HESC5R5334Z-H(Z009)	5.5	0.33	≤65	≤0.005	9.5	8.6	10.0
HESC5R5224Z-H(Z011)	5.5	0.22	≤50	≤0.005	11.5	8.6	10.0
HESC5R5334Z-H(Z011)	5.5	0.33	≤50	≤0.005	11.5	8.6	10.0
HESC5R5474Z-H(Z011)	5.5	0.47	≤50	≤0.005	11.5	8.6	10.0
HESC5R5105Z-H	5.5	1	≤20	≤0.02	19.0	9.2	19.0
HESC5R5155Z-H	5.5	1.5	≤20	≤0.02	19.0	9.2	19.0
HESC5R5405Z-H	5.5	4	≤16	≤0.03	25.0	9.0	25.0

产品图纸
Product drawings



0.1~0.47F 电容示意图
0.1~0.47F diagram
of capacitance

1.0~1.5F 电容示意图
1.0~1.5F diagram of
capacitance

4.0F 电容示意图
4.0F diagram of
capacitance

产品性能表
Product performance
table

纽扣常规系列-C&T 型
Button regular series-C&T

型号 Model	额定电压/V Rated voltage	标称容量/F Rated discharge capacitance	内阻(1KHz)/Q Nominal impedance(1KHz)/Ω	漏电流(24h)/mA Leakage current (24 h)/mA	Φ/mm Diameter	H/mm Height/mm	P/mm Spacing/mm
HESC5R5104Z-C	5.5	0.1	≤50	≤0.005	13.0	13.0	5.0
HESC5R5224Z-C	5.5	0.22	≤50	≤0.005	13.0	13.0	5.0
HESC5R5334Z-C	5.5	0.33	≤50	≤0.005	13.0	13.0	5.0
HESC5R5474Z-C	5.5	0.47	≤50	≤0.005	13.0	13.0	5.0
HESC5R5684Z-C	5.5	0.68	≤20	≤0.02	20.5	12.5	5.0
HESC5R5105Z-C	5.5	1	≤20	≤0.02	20.5	12.5	5.0
HESC5R5155Z-C	5.5	1.5	≤20	≤0.02	20.5	12.5	5.0
HESC5R5224Z-T(Z009)	5.5	0.22	≤65	≤0.005	9.5	5.5	16.2
HESC5R5334Z-T(Z009)	5.5	0.33	≤65	≤0.005	9.5	5.5	16.2
HESC5R5474Z-T(Z011)	5.5	0.47	≤50	≤0.005	11.5	5.5	19.0
HESC5R5105Z-T	5.5	1	≤20	≤0.02	19.0	5.5	26.0
HESC5R5155Z-T	5.5	1.5	≤20	≤0.02	19.0	5.5	26.0

产品图纸
Product drawings

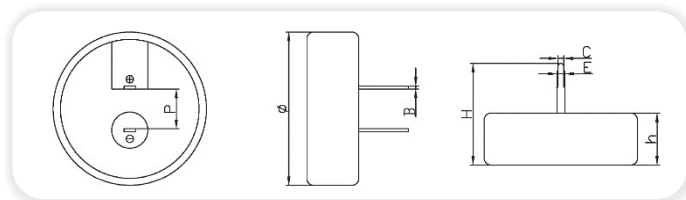

C型超级电容器
C type super capacitor

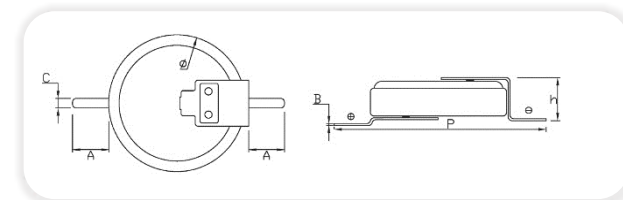

T型超级电容
T type super capacitor

产品性能表
Product performance table

纽扣高温系列—V型、H型、C型
Button high temperature series-V、H、C

型号 Model	额定电压/V Rated voltage	标称容量/F Rated discharge capacitance	内阻(1KHz)/Q Nominal impedance(1KHz)/Ω	漏电流(24h)/mA Leakage current (24 h)/mA	Φ/mm Diameter	H/mm Height/mm	P/mm Spacing/mm
HTSC5R5105Z-V	5.5	1	≤30	≤0.02	19	23	4.5
HTSC5R5155Z-V	5.5	1.5	≤30	≤0.02	19	23	4.5
HTSC5R5105Z-H	5.5	1	≤30	≤0.02	19	9.2	19
HTSC5R5155Z-H	5.5	1.5	≤30	≤0.02	19	9.2	19
HTSC5R5105Z-C	5.5	1	≤30	≤0.02	20.5	12.5	5
HTSC5R5155Z-C	5.5	1.5	≤30	≤0.02	20.5	12.5	5
HTSC5R5474Z-C(C003)	5.5	0.47	≤30	≤0.02	20.5	14.5	5
HTSC5R5684Z-C(C003)	5.5	0.68	≤30	≤0.02	20.5	14.5	5
HTSC5R5105Z-C(C003)	5.5	1	≤30	≤0.02	20.5	14.5	5

产品图纸
Product drawings

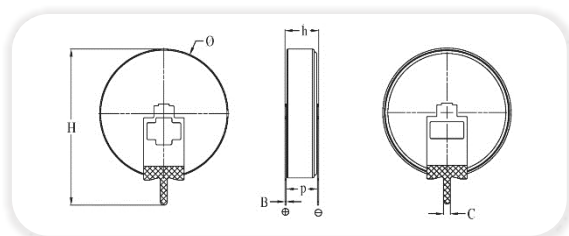

1.0~1.5F 电容示意图
Diagram of capacitance

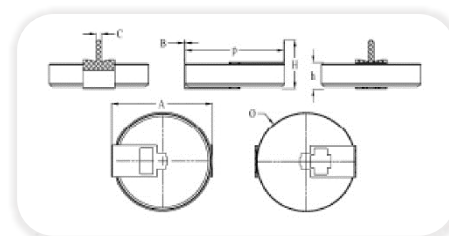

1.0~1.5F 电容示意图
Diagram of capacitance

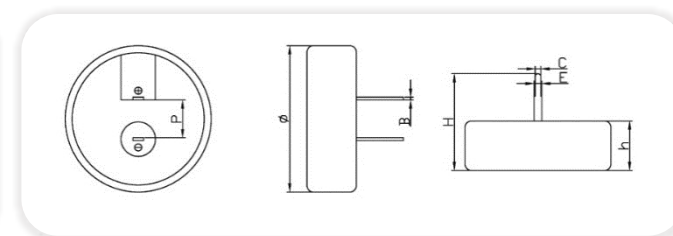

C型超级电容
C type diagram of capacitance